

depend-o



drain

Manufacturers of Plastic Valves and Custom Injection Molded Products

VALVE SPECIFICATIONS

	MDB-2	MDB-3	MDB-3RA	MDP-2	MDP-2RA	MDIV
MAXIMUM AMBIENT AIR TEMPERATURE (WITHOUT MOTOR COVER)	120° F (49° C)	120° F (49° C)	120° F (49° C)	120° F (49° C)	120° F (49° C)	120° F (49° C)
MAXIMUM FLUID TEMPERATURE	180° F (82° C)	180° F (82° C)	180° F (82° C)	180° F (82° C)	180° F (82° C)	180° F (82° C)
ELECTRICAL SUPPLY TOLERANCE RANGE OF OPERATION	+10%, -15%	+10%, -15%	+10%, -15%	+10%, -15%	+10%, -15%	+10%, -15%
MAXIMUM HEAD PRESSURE AT LOWEST ELECTRICAL SUPPLY INPUT	6 PSI (0.4 BAR)	6 PSI (0.4 BAR)	6 PSI (0.4 BAR)	2 PSI (0.13 BAR)	2 PSI (0.13 BAR)	25 PSI (1.7 BAR)
MAXIMUM PULL OUT FORCE ON THE MOTOR TERMINAL CONNECTOR	30 LBS (16 KGS)	30 LBS (16 KGS)	30 LBS (16 KGS)	30 LBS (16 KGS)	30 LBS (16 KGS)	30 LBS (16 KGS)
VALVE HOUSING MATERIAL (PLASTIC)	PP	PP	PP	PP	PP	PHENOLIC
VALVE CERTIFICATIONS	U.L., C.S.A., SEMKO	U.L., C.S.A., SEMKO	U.L., C.S.A., SEMKO	U.L.	U.L.	U.L., C.S.A.
OVERFLOW PORT	OPTIONAL	OPTIONAL	N.A.	OPTIONAL	N.A.	N.A.

- 1) Dimensions 'A', 'B', 'C', 'D' and 'E' to customer specifications.
- 2) Motor voltage and cycles (Hz) to customer specifications.
- 3) Other custom features available on request.



1.4.02

MOTOR COVER OPTIONS

<p>MDB-2 VALVE WITH A DRIP SHIELD DRIP SHIELD PART NUMBER 900096 IP RATING = IP01</p>	<p>MDB-2 VALVE WITH SPLASH GUARD SPLASH GUARD WITH A WIRE LEAD SLOT PART NUMBER 900165 IP RATING = IP43</p>	<p>MDB-2 VALVE FOR IMPACT AND FLAME RESISTANCE MOTOR COVER PART NUMBER 900087 IP RATING = IP66</p>
---	---	--

PD4 4 inch valve

(Pneumatically Operated)



RIGHT OUTLET



LEFT OUTLET

Feature	Specification
Construction	Right angle pneumatic operated piston valve
Valve Housing Color	Black only
Valve Orientation	1) Inlet on top 2) Inlet on side, outlet horizontal on side 3) Inlet on side, outlet pointed toward ground
Fluid Media	Low aggressive media as used in laundry or food sanitation requirements
Max. Fluid Temperature	100°C
Max. Ambient Temperature	50°C
Inlet Port Nominal Outside Diameter	115 MM (4.5 Inches)
Outlet Port Nominal Outside Diameter	115 MM (4.5 Inches)
Internal Fluid Operating Pressure (at 90 PSI pneumatic pressure to the cylinder)	0.3 Bar (5 PSI)
Maximum Air Cylinder Pressure	6.8 Bar (100 PSI)
Minimum Air Cylinder Pressure to hold minimum 2.5 PSI of medium pressure	4.1 Bar (60 PSI)
Materials:	
Valve Housing	POM
All Metal Parts (internal and external)	Stainless Steel
Rubber Seals	EPDM
CV (air flow) rating for supply air lines to pneumatic cylinder	CV= 0.15 max. Maximum 1.7 cm ³ /sec. (0.10 in ³ /per sec.)
Valve operation time at 90 PSI and CV= 0.15 in ³ /sec	
To Close	Approximately 0.5 sec.
To Open	Approximately 0.5 sec.

Depend-O-Drain, Inc.

6012 33rd Street East, Bradenton, FL, USA 34203

Tel.: (941) 756-1710 Fax: (941) 758-9178 E-mail: info@dependodrain.com

PD4 4 inch valve

(Pneumatically Operated)

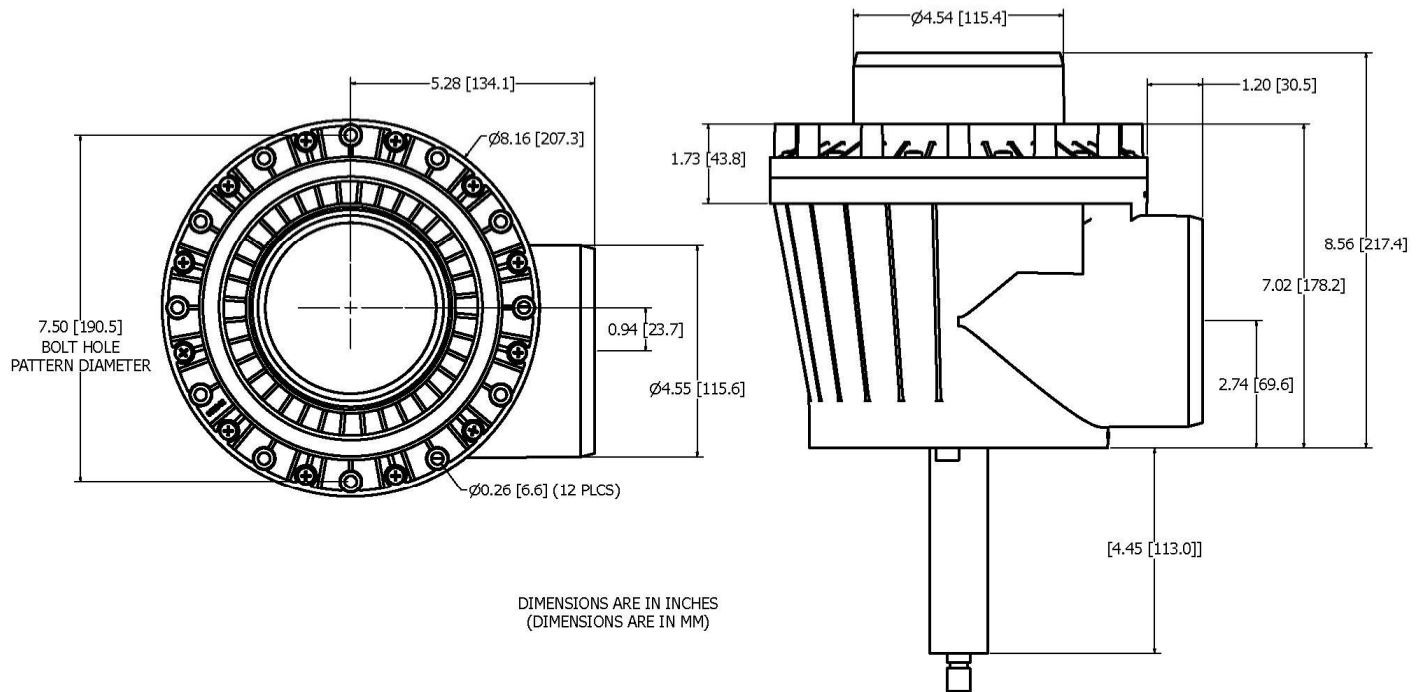

Mechanical features:

- The inlet and outlet ports are designed to be a true 4" plumbing pipe size.
- The valve operation (straight push/pull actuation) dictates the right angle design of the valve.
- The inlet and outlet faces are inverted curves to add strength and support these faces from deformation when the valve actuator exerts 80 lb force when the valve is closed.
- The ports are designed for a hose and hose clamp fitting.
- The outlet port is designed so that the inside diameter of the port lays flush to the inside bottom and one side of the valve housing.
- The seal plate is designed with generously located ribbing to support the 80 lb force of the cylinder.
- The air cylinder is mounted to the housing with a threaded end cap on the cylinder.
- The inlet and housing are held together with stainless steel screws.
- A universal mounting bracket can be supplied as an option.

Depend-O-Drain, Inc.

6012 33rd Street East, Bradenton, FL, USA 34203

Tel.: (941) 756-1710 Fax: (941) 758-9178 E-mail: info@dependodrain.com